

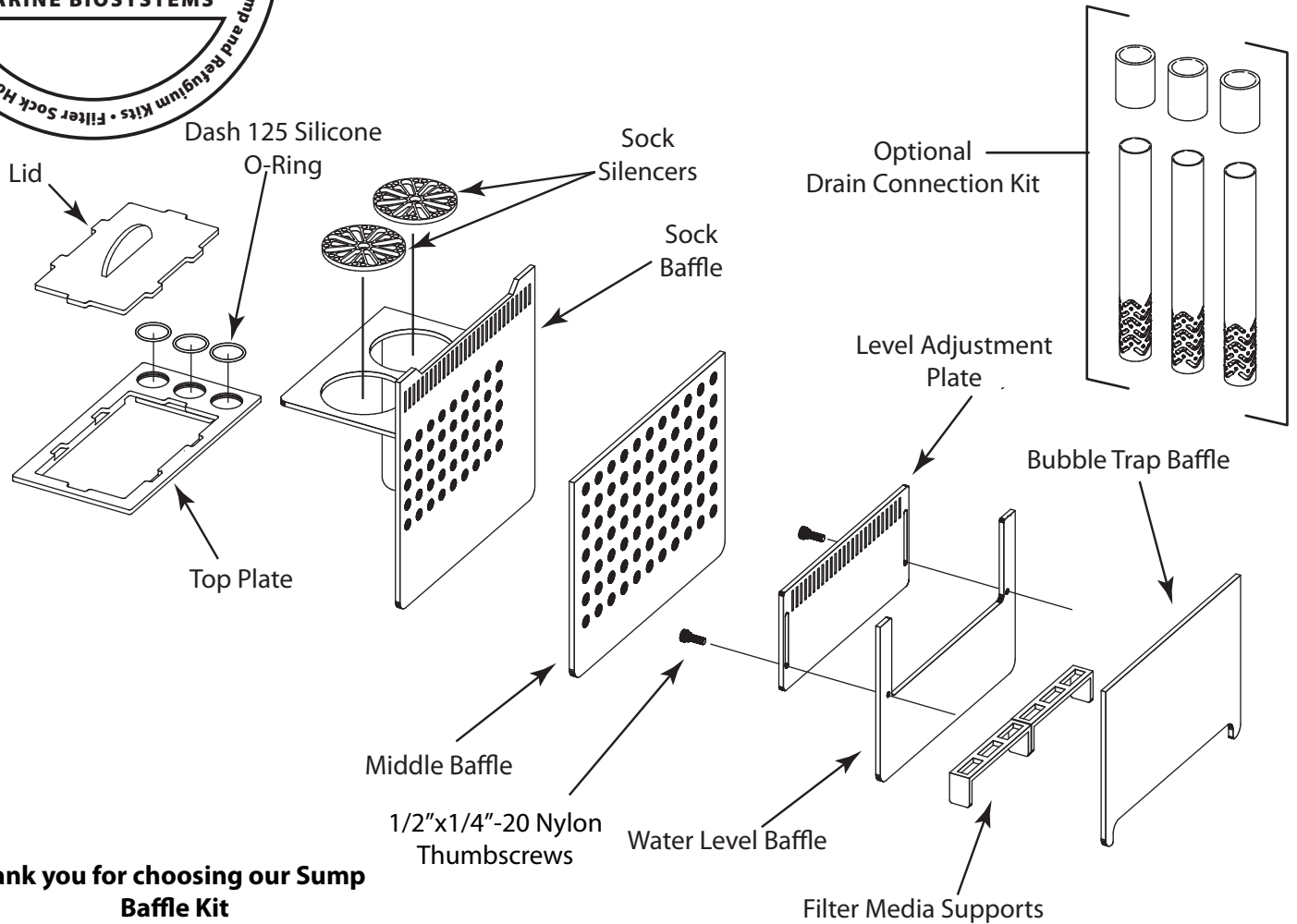

PRO 5 ZONE ADJUSTABLE DEPTH BAFFLE KIT



Thank you for choosing our Sump Baffle Kit

Assembly is quick and easy.

First, please inspect all parts. The following parts should be in the package:

- | | |
|------------------------------------------------|--------------------------------------------------|
| 1.) Top Plate | 2.) Lid with installed Dash 125 Silicone O-rings |
| 3.) Main Sock Baffle | 4.) Middle Baffle/Divider |
| 5.) Water Level Baffle | 6.) Water Level Adjustment Plate |
| 7.) 2 x Filter Media Supports | 8.) Bubble Trap Baffle |
| 9.) 2 x 1/2" x 1/4"-20 Black Nylon Thumbscrews | 10.) 2 x High Flow Sock Silencers |
| 11.) 1 x Spare Dash 125 O-Ring | 12.) Optional: Drain Connection Kit (if ordered) |

If anything is missing or damaged in shipping please contact us ASAP for a replacement. Our contact info is below, or you can contact us through my Ebay store at <https://www.ebay.com/str/marinebiosystems>.

If you need any other acrylic products for your aquarium we welcome you to shop at <https://www.ebay.com/str/marinebiosystems> or contact us directly. We offer a wide variety of products and build custom items to order.

Assembly Notes

Our standard Sump/Refugium Conversion Kits are manufactured specifically to fit standard rimmed Aqueon® glass tanks. If your tank is not an Aqueon tank, please contact us and we'll do what we can to get the appropriate parts for your specific tank. Even if it is an Aqueon tank, the parts still may not fit "perfectly" due to variations in manufacturing allowed by Aqueon quality control. We typically see 1/16" or a little more variation in tank width between tanks and in many cases even along the length of the same tank. Please be sure you TEST FIT your parts with your specific tank prior to attempting a permanent installation. We will not accept returns for parts once you attempt to glue them in.

The top plate/lid assembly should fit within the recess of the top support ring with a slight bit of play.

The internal baffles should be snug to 3/32" short on width. If they are too tight, or if the gap is greater than 1/8" please contact us and we'll work out a solution for you.

Once you have established that the parts fit correctly then remove any protective sheeting. This can be either a thin white plastic film, or a thin brown paper film covering one or both sides of the parts. Not all sides or parts will have the film. If the surface is black or clear then the film was removed in the manufacturing process.

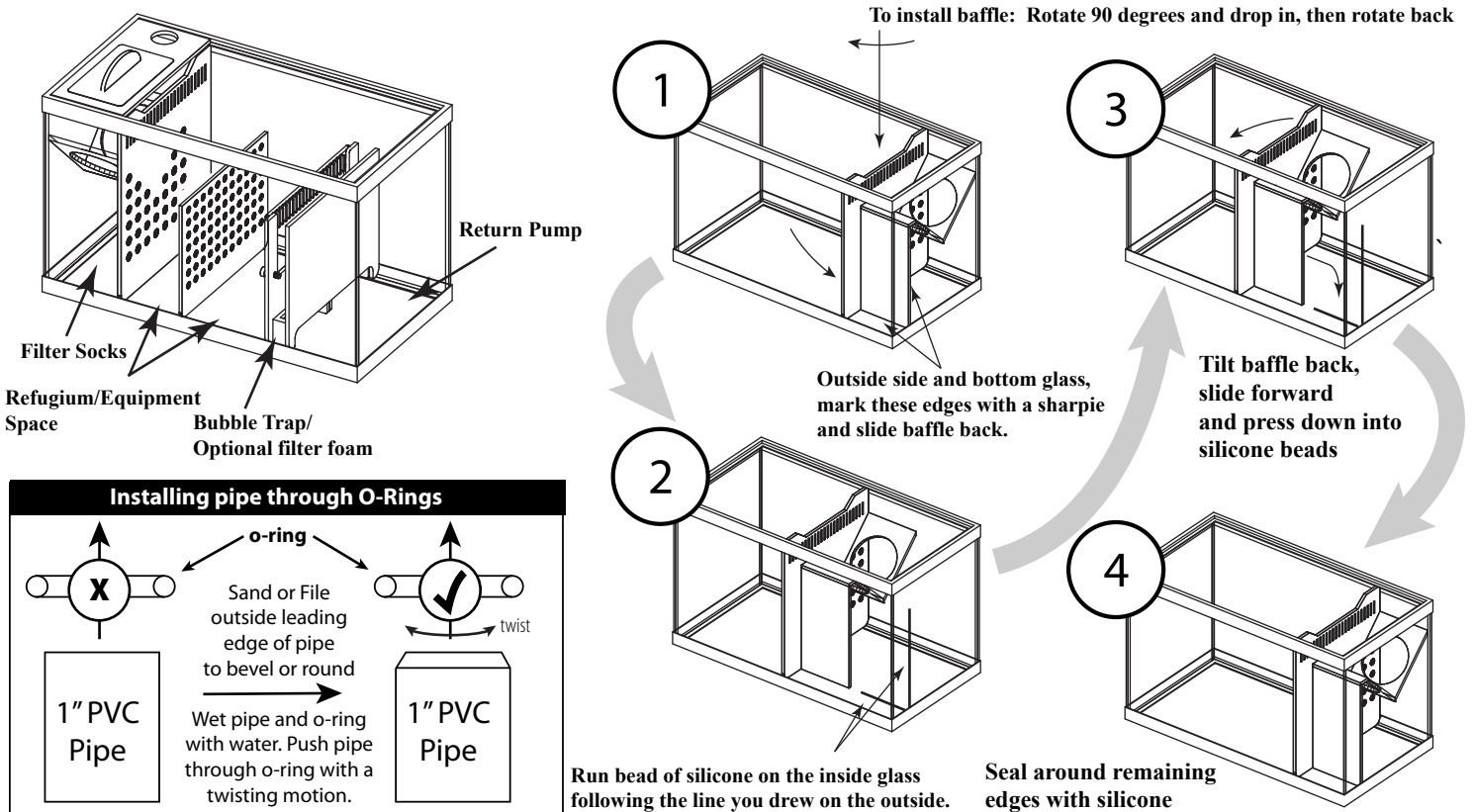

Installation:

- 1.) The left drawing above shows the typical installation of the parts and the corresponding chambers they create.
- 2.) The filter sock baffle should be installed first. The available space around the vertical separator on the sock holder can make sealing that plate a challenge. The best way to do it is to position the baffle where you want it. Then, using a sharpie or other felt tipped marker, draw a line along the length of the baffle on the outside of the glass. Pull the baffle back and run a bead of silicone along the line on the inside of the glass. Tilt the baffle back, slide it into position and press it down into the bead of silicone. Any Sharpie lines on the outside glass are easily removed with rubbing alcohol. (See 4 right pictures above)
- 3.) The spacing between the remaining baffles should be established prior to gluing. We recommend measuring all your components (skimmers, reactors, etc.) that you plan to place in each compartment, or putting them in the tank and fitting the baffles around them.
- 4.) The bubble trap space should be at least 1" (the width of the included filter media supports), but can be more if you want to install wider filter foam material between the plates. In which case, space them accordingly to fit the foam size you plan to use.
- 5.) Once the baffles are in place, run a bead of aquarium safe silicone along the edges where the baffle meets the glass to seal them in. You can use a drop of cyanoacrylate glue (superglue, corafix, etc.) between the bottom edge of the baffle and the tank floor to hold the baffle in place while you silicone.
- 6.) Allow the silicone to cure to the silicone manufacturer's instructions.
- 7.) To install the top plate/lid assembly we recommend running a bead of silicone along the inside of the tank top brace inset where the lid frame will lay. Drop the lid frame in place, press down to ensure good contact and let cure.
- 8.) Installation of drain plumbing. This kit comes with Dash 125 silicone o-rings pre-installed in the inlet holes. These are intended to seal against 1" PVC pipe to prevent salt creep. They can be easily removed if you do not want to use them. To install your own 1" PVC pipe with the seals make sure you round or bevel the ends of the pipe with sand paper or a file. The pipe included with our drain connection kit is pre-beveled for you. Wet the o-rings and the pipe with water and push the pipe through with a twisting motion. Watch the o-ring closely, if it appears to be pushing out of the retaining slot then stop and add more bevel to your pipe rim.
- 9.) Fill the tank and test it out.